

Special Features

- Polypropylene case with SS measuring system
- Wetted parts AISI 316L stainless steel
- Accuracy $\pm 0.5\%$ F.S.
- Solid front design features baffle wall interposed between the sensing system, the window and a pressure relieving back for increased safety
- Standard followed ASME - B 40.100

Application

- Suitable for high pressure gas
- Corrosive / hazardous environment that will not obstruct the pressure system.

Specifications

Standard Version : 4 1/2"

Accuracy	:	$\pm \pm 0.5\%$ F. S. (As per ASME B40.100)
Ambient temperature	:	- 20°C to + 65°C
Process temperature	:	Max 150°C
Operating pressure range	:	75 % of Scale Value
Over pressure limit	:	≤ 100 bar : 125% of Max. Scale Value > 100 to ≤ 600 bar : 115% of Max. Scale Value > 600 to ≤ 1600 bar : 110% of Max. Scale Value

Case	:	Fibre Glass Reinforced Polypropylene
Bourdon	:	AISI 316L SS
Socket	:	AISI 316L SS
Movement	:	AISI 304 SS
Joints	:	Tig Argon Arc Welding

Protection	:	IP 65
Dial	:	Aluminium, black graduation on white background
Pointer	:	Aluminium, black Coloured, Micrometer Zero Adjustable
Window	:	Shatterproof/Safety Glass
Blow off Disc	:	Fibre Glass Reinforced Polypropylene
Gasket	:	Neoprene

Dry But Fillable Version (Option FG)

Fillable Dampening	:	Glycerine 99.7%
Liquid Ambient	:	Maximum 65°C
Temperature Process	:	Maximum 65°C
Temperature Other	:	Refer Specification
Features	:	of Standard Version

Glycerine Filled Version (Option PY)

Accuracy	:	$\pm 1.0\%$ of F. S.
Ambient Temperature	:	Maximum 65°C
Process Temperature	:	Maximum 65°C
Dampening Liquids	:	Glycerine 99.7%
	:	(Others available as Option)
Other Features	:	Refer Specification
	:	of Standard Version
Protection	:	IP 65

Temperature effect:

The variation of indication caused by effects of temperature is to be calculated by below formula; which is to be added in the specified accuracy while measurement :- Formula : $\pm 0.04 \times (t_2 - t_1) \%$ of F. S. where t_1 = reference temperature (+20°C) and t_2 = ambient temperature in °C.

Dimensions - standard version

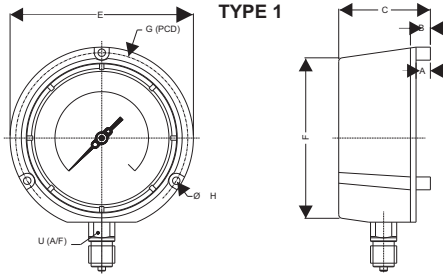

NS	A	B	C	E	F	G	H	U	Weight in gram (With Box)	Weight in gram (With Glycerin & Box)
4 1/2"	12.5	24.5	73.5	148	130	137.5	6	22	900.0	1300.00

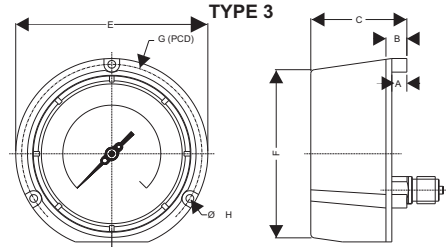

NS	A	B	C	E	F	G	H	U	Weight in gram (With Box)
4 1/2"	12.5	24.5	73.5	148	130	137.5	6	22	850.0

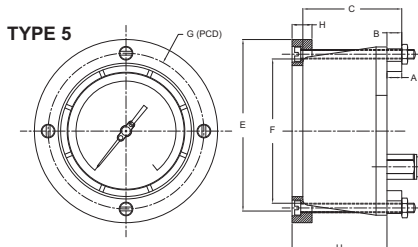

NS	A	B	C	E	F	G	H	U	Weight in gram (With Box)
4 1/2"	12.5	24.5	73.5	148	130	137.5	6	22	1000.0

Notes : • Drawings are not to scale. • All Dimensions are in mm. • NS = Nominal Size
 • H - Arrangement for Mounting type 1 • Weights mentioned are approximate and for standard product. • Weight can be different after selection of options.

Note : We offer National / International Scales like kPa, MPa, bar, psi, kg/cm² & Dual Scale like kPa with psi, kPa with bar, bar with psi or Equivalent scales as per the requirement can be provided on request. Following are the example tables for kg/cm² & psi scales

Pressure Range

Single Scale (kg/cm² or bar)

0/0.6	0/4	0/25	0/160	0/1000
0/1	0/6	0/40	0/250	0/1600
0/1.6	0/10	0/60	0/400	
0/2.5	0/16	0/100	0/600	

Dual Scale (kg/cm² with psi)

psi	kg/cm ²	psi	kg/cm ²	psi	kg/cm ²
0/15	0/1	0/400	0/28	0/4000	0/280
0/30	0/2	0/500	0/35	0/5000	0/350
0/60	0/4	0/600	0/40	0/6000	0/400
0/100	0/7	0/1000	0/70	0/10000	0/700
0/150	0/10	0/1500	0/100	0/15000	0/1000
0/220	0/16	0/2200	0/160	0/22000	0/1600
0/300	0/20	0/3000	0/200		

Vacuum & Compound Range

Dual Scale

inHg with psi	mmHg with kg/cm ²	inHg with psi	mmHg with kg/cm ²	inHg with psi	mmHg with kg/cm ²
- 30/0	- 760 / 0	- 30/60	- 760 / 3	- 30/200	- 760 / 15
- 30/15	- 760 / 1	- 30/100	- 760 / 6	- 30/300	- 760 / 20
- 30/30	- 760 / 2	- 30/150	- 760 / 9	- 30/350	- 760 / 24

Single Scale (kg/cm²)

- 1/0	- 1/1.5	- 1/5	- 1/15
- 1/0.6	- 1/3	- 1/9	- 1/24

Accessories (Refer Datasheet for complete specifications)

EB Cooling tower	EC Gauge cock	ED Over load protector (gauge saver)**
* Needle valve	EG Snubber	EH Siphon

* Refer catalogue for Valves & Manifolds. ** For Pressure Ranges.

How To Order			Example
Basic Model			AH
Code			
Nominal Size		G	
		4 1/2"	X
Type of Mounting			
1	Wall / surface / projection mounting with bottom entry		
3	Direct lower back entry (never fillable)		
5	Lower back entry with front flange		X
Gauge Connection			
3BM	3/8" BSP (M)		
4BM	1/2" BSP (M) Standard		
2NM	1/4" NPT (M) Standard		XXX
4NM	1/2" NPT (M) Standard		
Note : Connections like Metric/ PT/ PF/ Flaired/ UNF/ G/ R etc can be provided on request.			
Range			
Refer range table			0/10 kg/cm ²
Optional Extras			
OB	Accuracy 1.0% of F.S.	RX	Shatterproof / safety glass
TI	Monel bourdon & socket (Monel version)**	TF	Conformity as per NACE Standard
PW	Five point calibration certificate	FS	Fillable liquid silicon oil*
PU	Calibration certificate traceable to National / International standards	FG	Fillable liquid glycerine
RH	Custom designed dial	SF	Movement with dampening jelly
SG	Oxygen service (for dry version)	QB	Integral dampening screw (AISI 316 SS)
SW	Dial tag marking	FL	Integral dampening screw (monel)**
SX	SS tag plate	PZ	Dampening liquid mineral liquid filled
TB	Helium leak test	PX	Dampening liquid flourolube filled
RR	Enclosure protection IP 66	PY	Dampening liquid glycerine filled
SD	AISI 316 SS movement	QA	Dampening liquid silicon oil filled*
		ZL	Over Range Protection 150% of F.S.
		GH	Material test certificates***
* Gasket & Filling plug of Viton.			
** Integral dampening screw will be in monel if ordered. Refer option			
*** Material certificates test will be provided for wetted parts only with chemical composition testing. For others, please consult factory.			

Ordering Example: AH . X . X . XXX . 0/10 kg/cm² . XX

For other optional items, please contact factory for delivery and minimum quantity of order.

 Note : Specifications and dimensions given in this product catalogue represents the state of engineering at the time of printing .
 Modifications may take place and materials specified may be replaced by others without prior notice.